

# EP100

## Standalone Proximity Reader

- Simple Design ■
- Proximity Card Technology ■
- Standalone Architecture ■
- Reliable Technology ■



# EP100

## Specifications

- Standalone Operation
- Onboard Memory EEPROM
- Firmware Flash Memory
- Store Up to 1000 Cards & 5 Master PIN Code
- Integrated 12-Touch Keypad
- Onboard Buzzer
- LED Indication
- Reader Format - EM Format
- 5-8cm Reading Range
- Continuous Card Read When Door Is Opened
- Configurable Lock Release Time (1-99 sec)
- Operation Mode PIN, CARD , CARD + PIN
- I/O - NO/NC Lock, Door Sensor, Push Button, Door Bell
- Polarity Protection For Power Input
- Power - 12VDC
- Operation Current - Typical 500mA
- Operation Temperature 0°C - 70°C
- Dimensions : 10cm (W) x 11.5cm (H) x 2.3cm (D)

## System Configurations

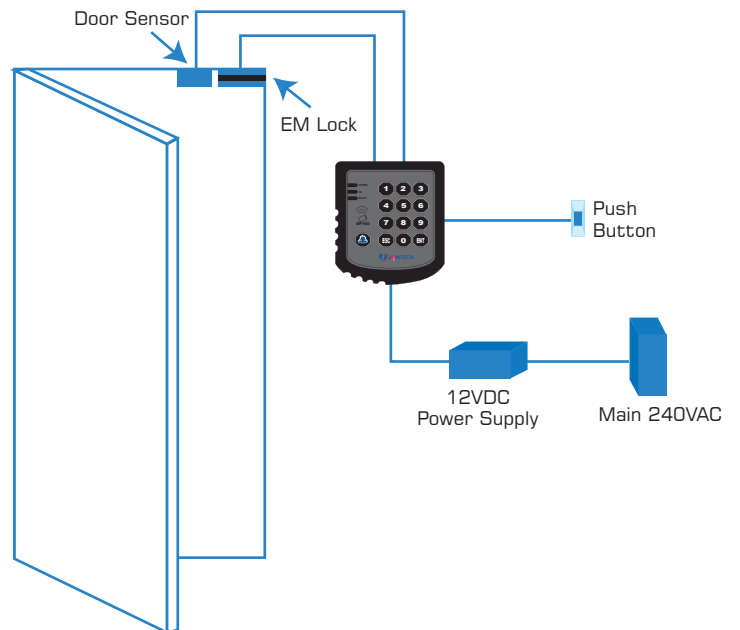

Distributed by: